

GP Batteries

Data Sheet

Model No.: PX625A

Description : Alkaline Button Cell
 Nominal Voltage : 1.50 Volts
 Nominal Dimensions : Ø15.6 X 5.95mm
 Applications : Electronic toy, camera, etc
 Average Weight : 2.9g
 Shelf Life : Not less than 90% of the service capacity, for 1 year storage at 20°C.
 Date Code : Unless otherwise specified, each cell will carry a numeric year code and an analog month code.

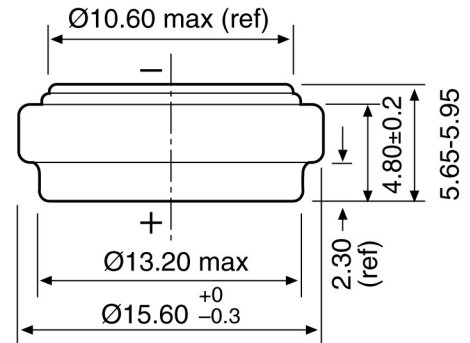

Unit : mm

Nominal Service Life : 18 hrs (at 125Ω Load)
 (to 0.9V at 20°C)

Typical Discharge Characteristics at 20°C

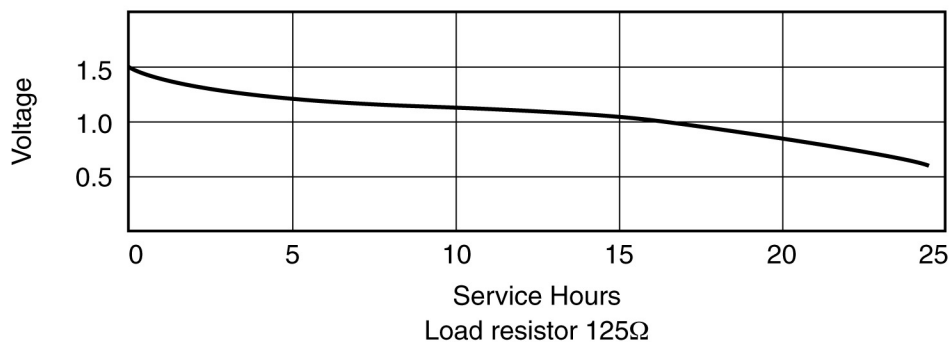

Average Service Capacity:
 190mAh (rated capacity at 470Ω load,
 cut off voltage 0.9V at 20°C)

Close circuit voltage:
 1.35 Volts (min.) (load resistor 100Ω at
 20°C for 1 to 2 seconds)

Cross Reference:

IEC	JIS	Varta	Duracell
LR9	LR9	V625U	PX625A