

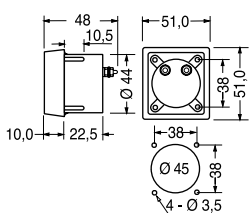

STRUMENTI ANALOGICI 51x51mm - 45x45mm

Caratteristiche comuni a tutti i modelli:

- Corpo in resina antiurto con scala frontale trasparente
- Dispositivo meccanico di azzeramento



ART.	Portata	Resistenza Interna	Tipologia	Classe	Confezioni	
					Com.	Ind.
09/00510-00	0 ÷ 30 Vca	1,8KΩ	Ferro Mobile	2,5	1	5
09/00520-00	0 ÷ 60 Vca	3,6KΩ	Ferro Mobile	2,5	1	5
09/00530-00	0 ÷ 300 Vca	18KΩ	Ferro Mobile	2,5	1	5

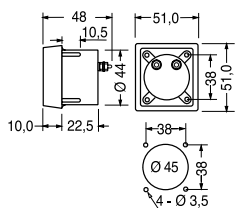

09/00600-00	0 ÷ 1,5 Aca	0Ω	Ferro Mobile	2,5	1	5
09/00620-00	0 ÷ 5,0 Aca	0Ω	Ferro Mobile	2,5	1	5
09/00630-00	0 ÷ 10 Aca	0Ω	Ferro Mobile	2,5	1	5
09/00640-00	0 ÷ 15 Aca	0Ω	Ferro Mobile	2,5	1	5
09/00650-00	0 ÷ 25 Aca	0Ω	Ferro Mobile	2,5	1	5

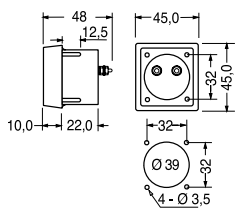

09/00700-00	0 ÷ 15 Vcc	15KΩ	Bobina Mobile	2,5	1	5
09/00710-00	0 ÷ 30 Vcc	30KΩ	Bobina Mobile	2,5	1	5
09/00720-00	0 ÷ 60 Vcc	60KΩ	Bobina Mobile	2,5	1	5
09/00730-00	0 ÷ 300 Vcc	300KΩ	Bobina Mobile	2,5	1	5

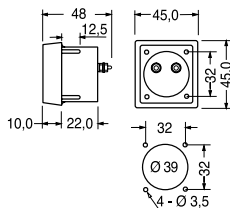

09/00750-00	0 ÷ 1 Acc	0,018Ω	Bobina Mobile	2,5	1	5
09/00760-00	0 ÷ 3 Acc	0,006Ω	Bobina Mobile	2,5	1	5
09/00770-00	0 ÷ 5 Acc	0,036Ω	Bobina Mobile	2,5	1	5
09/00780-00	0 ÷ 10 Acc	0,0018Ω	Bobina Mobile	2,5	1	5

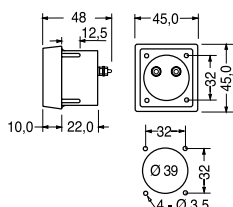

09/00800-00	0 ÷ 1 mA	200Ω	Bobina Mobile	2,5	1	5
--------------------	----------	------	---------------	-----	----------	----------

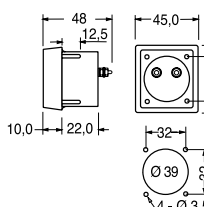

09/00810-00	0 ÷ 100 µA	1,89KΩ	Bobina Mobile	2,5	1	5
--------------------	------------	--------	---------------	-----	----------	----------